



Rockford Fosgate
MOTORSPORTS AUDIO

NEED HELP WITH YOUR INSTALLATION?



YOUTUBE VISIT OUR CHANNEL FOR A COMPLETE
INSTALLATION VIDEO AND OTHER TIPS
WWW.YOUTUBE.COM/USER/ROCKFORDFOSGATE



TECH SUPPORT
ROCKFORDFOSGATE.COM/SUPPORT
1-800-669-9899

IMPORTANT RIDE COMMAND® TUNING

If your system utilizes Ride Command® as the source unit, you may experience reduced output (loudness) based on the software version and may require important “level matching” for optimum performance. Do not reassemble vehicle until performing below tasks and listening to the audio output.

AUDIO KIT PURCHASED BEFORE MAY 2021

You may need to manually adjust the amplifier input levels using our C.L.E.A.N. setup procedure.



AUDIO KIT PURCHASED AFTER MAY 2021

You may need to move the PRESET switch to “OFF” and use our C.L.E.A.N. setup procedure.

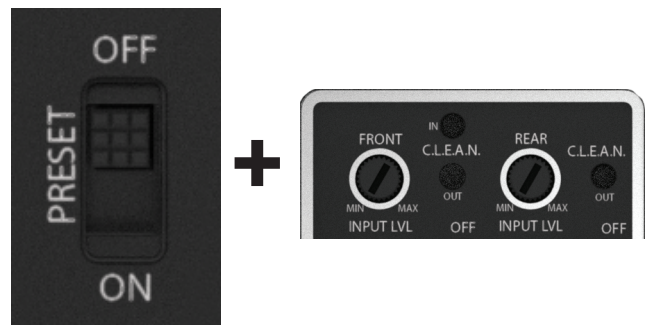

Contact Technical Support if you need assistance with tuning the amp using C.L.E.A.N. or the system is not performing to your expectations. Updating Ride Command® software may require you to redo the C.L.E.A.N. setup.