

## Product Overview

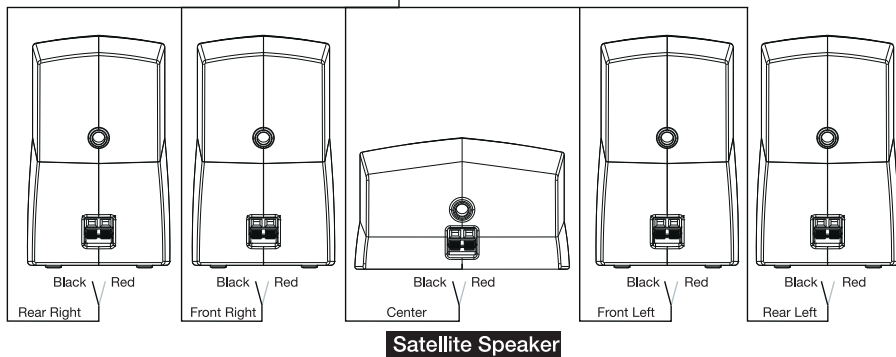

## Control Console Overview

1. Input selection: Use this button to switch between your audio source.(Optical, Line in, PCin, AUX in, Bluetooth)
2. Effect: Use this button to switch between 2.1 output or 5.1 output.
3. Bass: Press this button to adjust bass channel; when the BASS LED is on, you can adjust bass volume by rotating the knob.
4. Power: Master power on/off
5. Mute: Mute the entire system
6. Volume / level adjustment knob: Adjust master volume
7. IR remote sensor
8. Input selection indicator
9. Speaker output indicator
10. Decode indicator: LED will be on when Dolby Digital signal is detected.
11. Sound effect indicator: Either 2.1 output mode or 5.1 output mode.
12. Bass indicator: When LED is on you can adjust bass level.
13. Headphone output jack
14. AUX input jack

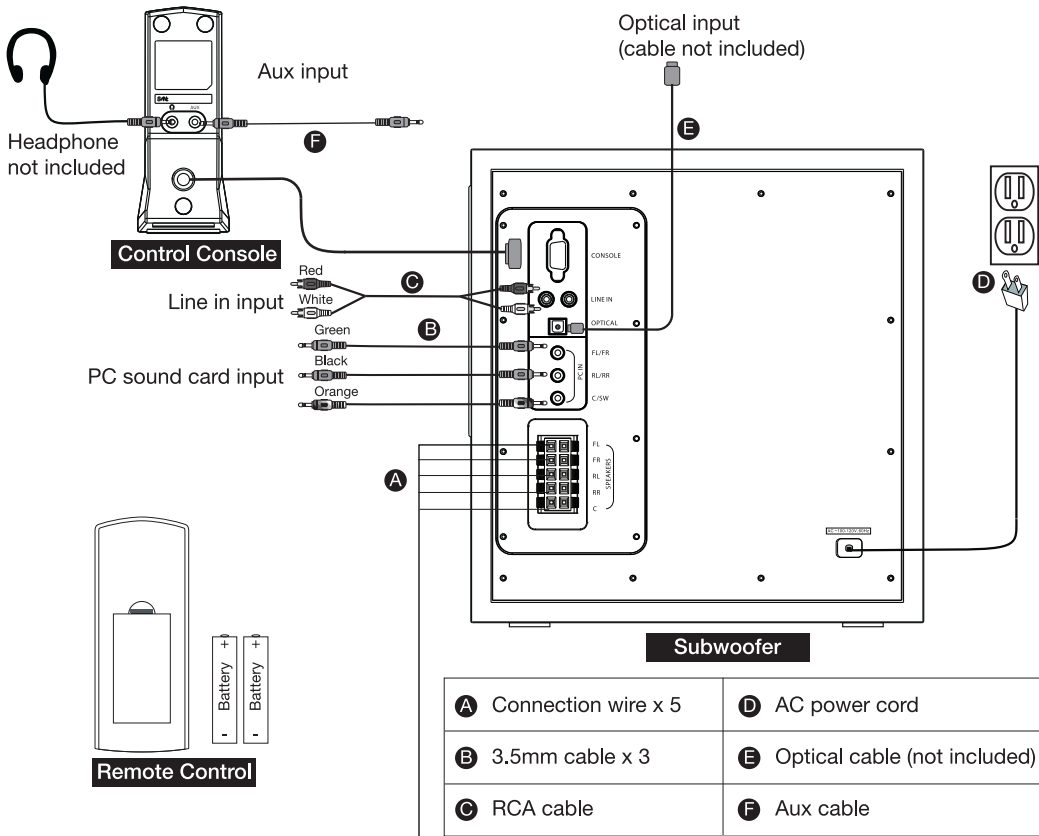
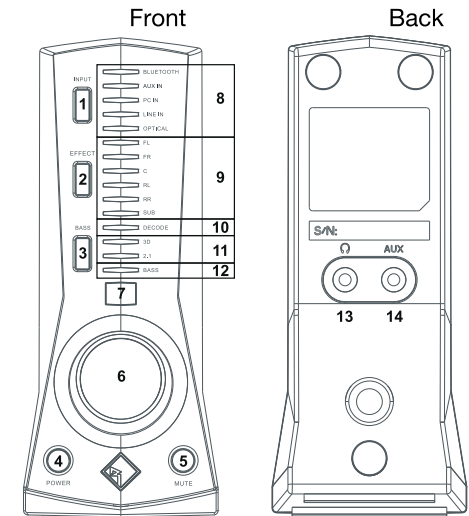

## Remote Control Overview

1. Input selection: Use this button to switch between your audio source. (Optical, Line in, PC in, AUX in, Bluetooth)
2. Effect: Use this button to switch between 2.1 output or 5.1 output.
3. Play: During Bluetooth connection, press this button to play or pause. Press and hold for 5 seconds to enter Bluetooth pairing mode.
4. Master volume: Up/Down
5. Mute the entire system
6. Master Power: On/Off

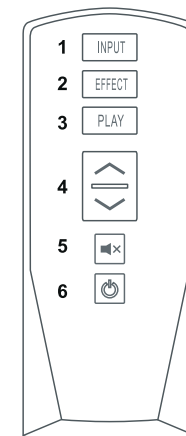

## Turning The Power On/Off

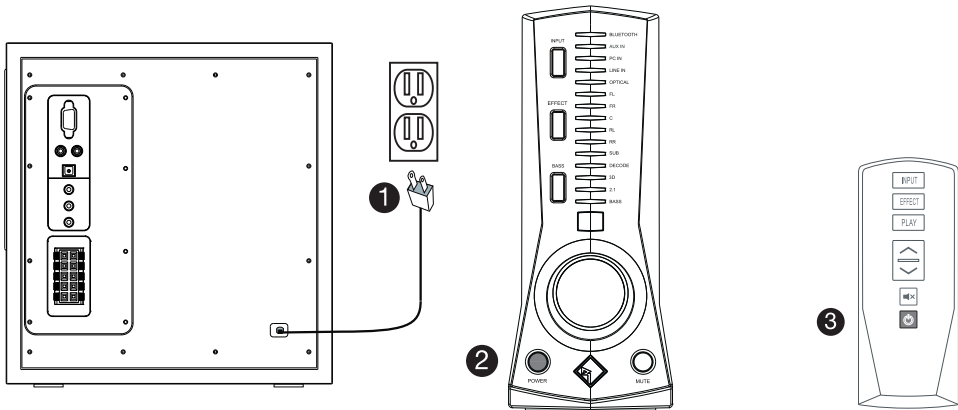

1. Connect the AC power cord to the wall socket
2. To turn the speaker on, press the POWER button on control console. Press once again to turn it off
3. You can also turn the speaker on/off by pressing the power button on the remote control

## Using The Speaker With Your Devices

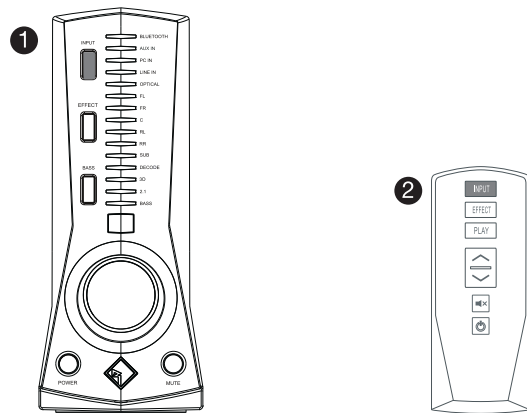

1. Choosing your source, press the INPUT button on control console to select input source
2. You can also select the input source by pressing the INPUT button on the remote control

## Choosing Your Source

