

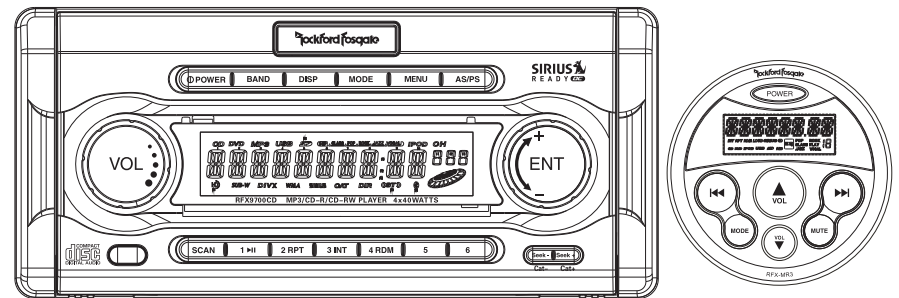

INSTRUCTION MANUAL

RFX9700CD



- CD-RECEIVER
- SIRIUS READY
- CD/CD-R/CD-RW/MP3/WMA PLAYER
- AM/FM STEREO RADIO
- IPOD SUPPORT
- PLAY USB MUSIC
- FLIP DOWN FRONT PANEL
- PLAY SD CARD MUSIC

Content

1.LOCATION OF PARTS AND CONTROLS.....	E2
2.LOCATION OF PARTS (REMOTE CONTROL) OPERATION.....	E3
3.WIRE CONNECTION METHOD.....	E4
4.INSTALLATION.....	E5
5.BASIE OPERATION.....	E6
6.SIRIUS OPERATION	E7-9
7.RADIO OPERATION.....	E10
8.IPOD OPERATION.....	E11
9.DISC OPERATION.....	E12
10.USB PORT.....	E13
11.TROUBLESHOOTING.....	E14
12.TECHNICAL SPECIFICATIONS.....	E15

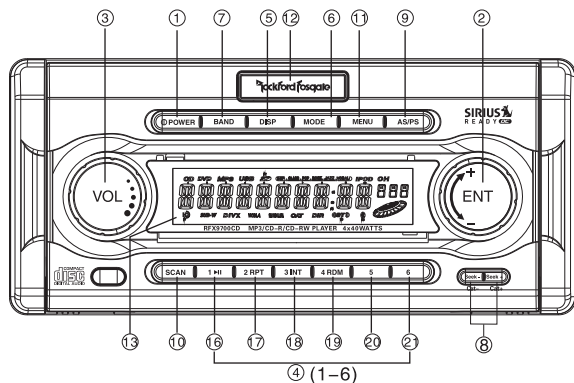

1. POWER ON/OFF (POWER) ① ⑳
2. ENTER ②
3. SELECT BUTTON ③ : VOL/BASS/TREBLE/BALANCE/FADER/SUBWOOFER/ID3 EQUALIZER
4. PRESET STATIONS (1.2.3.4.5.6) ④
5. DISPLAY BUTTON(DISP) ⑤
6. MODE BUTTON(MODE) ⑥ ㉑
7. BAND BUTTON (BAND) ⑦
8. AUTOMATIC TUNING ⑧ ㉒
(FREQ UP ►► OR FREQ DOWN ◄◄)
9. MANUAL TUNING ⑨
10. AUTO STORE AND PRESET SCAN/GOTO(AS/PS) ⑩
11. SCAN BOTTON (SCAN) ⑪
12. MENU BUTTON (MENU) ⑫
13. OPEN PANEL BUTTON() ⑬
14. LCD DISPLAY ⑬ ㉒
15. CD EJECT KEY ⑭
16. CD SLOT ⑮
17. PLAY/PAUSE BUTTON ⑯
18. REPEAT BUTTON ⑰
19. INTRO BUTTON(Preview all tracks) ⑱
20. RANDOM BUTTON ⑲
23. MUTE ㉓
24. VOL+/VOL- ㉑
28. SD SLOT ㉔

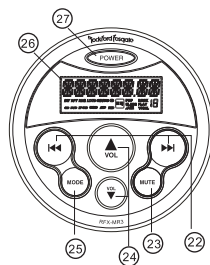

OPTION

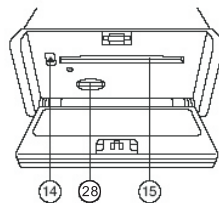

CD/MP3 PLAYER SECTION

Signal/Noise Ratio	>80dB
Frequency response	20HZ-20KHZ
Channel Separation	>60dB

TUNER(FM)

Frequency Range	87.5-107.9 MHz
Channel Step	200KHz
Sensitivity	2.8 μV
Stereo Separation	30dB
Signal to Noise Ratio	50dB

TUNER(AM)

Frequency Range	530-1710 KHz
Usable Sensitivity	32 dBmV

LINE-OUT

Output	5 V (max)
Impedance	10k Ohm

GENERAL

Power Supply	12V DC (10.8-15.6V allowable)
Speaker Impedance	4 or 8 ohm
Output Power	40W x 4CH
Fuse	10A

Note: Specifications and the design are subject to possible modification without notice due to improvement.

TROUBLESHOOTING

Problem	Cause	Corrective Action
Power light is off	Fuse disconnected or power wire open.	Check the fuse and power wire or ground wire connection.
No sound	No power voltage Speaker wire has come off	Check the power Check the speak wire
Does not read the Disc or repeatedly skips	Disc dirty or damaged The laser head is dirty	Clean or change the disc Clean the laser head.
Disc was not played	Disc putted incorrectly	Put disc with printing up
Will not read disc	1,Disc is broke or dusty 2,Laser is dusty	1,Replace disc 2,Clean the laser
Can not read some USB devices	The unit is not 100% compatible with all USB devices or the USB devices has special format.	Try to format the USB device in FAT 16/32 standard
Can not play some iPod	Some iPod is not compatible	
LCD can not display the Mp3 song name correctly	The songs are in foreign language or not in ID tag 3 format.	
After turn the power on, the unit powers off immediatly	The battery may be too low (the unit operating voltage is 10.8v to 15.6v).If the unit still cannot turn on, consult your dealer.	

WARRANTY

WARRANTY INFORMATION:

Should this product require service, you may obtain specific information by contacting the dealer from whom this product was purchased.

For any service related questions, Please call our technical service team.

Technical Support Phone Numger:574-848-2277

LOCATIONS OF PARTS (REMOTE CONTROL) OPERATION

- 1、POWER
- 2、MODE
- 3、EJECT
- 4、SCAN
- 5、AS/PS
- 6、BAND
- 7、MUTE
- 8、PLAY/PAUSE
- 9、REPEAT
- 10、INTRO
- 11、RANDOM
- 12、SELECT
- 13、MENU
- 14、GOTO
- 15、DISP
- 16、VOL+ /VOL-
- 17、REWIND/FORWARD
- 18、ENT
- 19、NEXT/ PREVIOUS
- 20、NUM0~NUM9

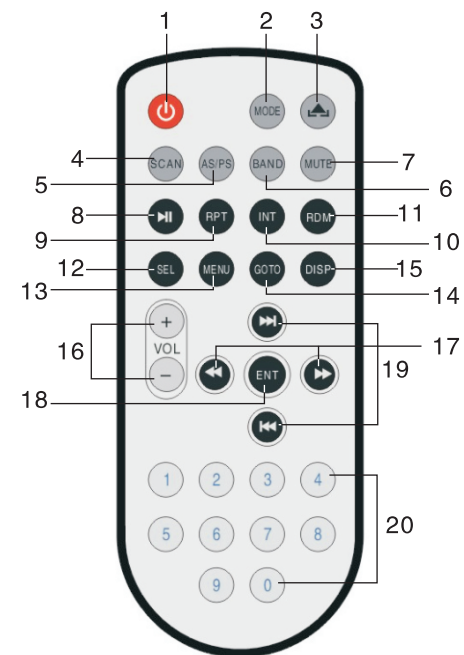

(OPTION)

WIRE CONNECTION

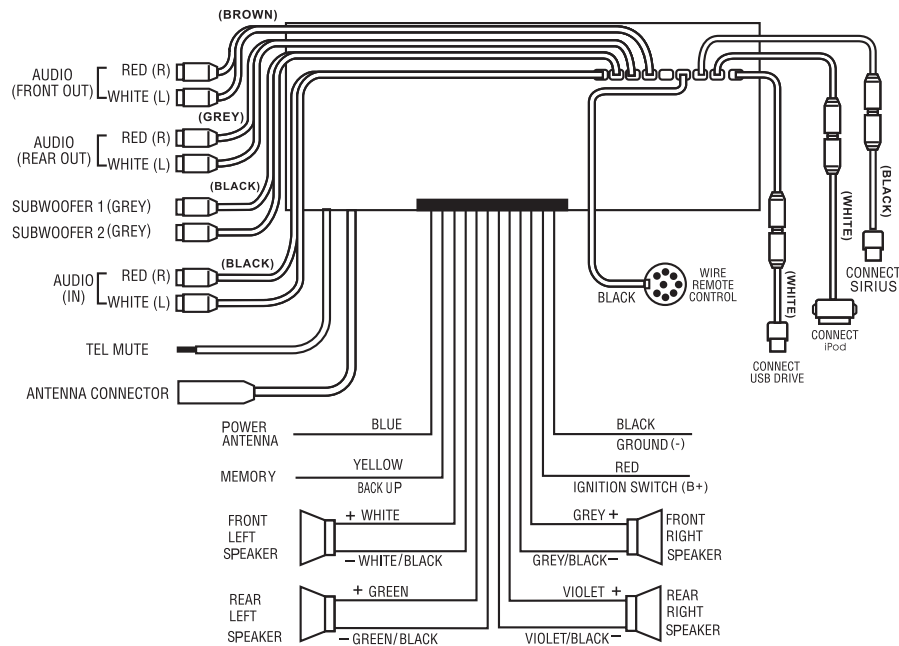

Maintenance

FUSE REPLACEMENT

If the fuse blows, check the power connection and replace the fuse. If the fuse blows again after the replacement, there may be an internal malfunction. In this case, consult your nearest repairing center.



Warning:

Only replace fuse with the same type and rating. Use of a different type or rating may cause serious damage.

USB AND SD/MMC MEMORY CARD OPERATION

USB PORT

Plug your USB memory stick directly into the USB cable. Unit starts playback automatically.

PLAYING SD/MMC MEMORY CARD FILES

- 1.Support MP3/WMA ID3 format music only.
- 1.Press OPEN (12) button to open the front panel.
- 2.Insert the SD/MMC card into the card slot.
- 3.Close the front panel, the unit will play songs in SD card automatically

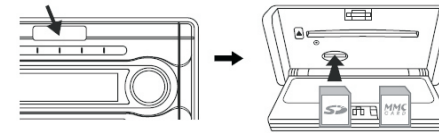

You may press SEEK+ as "10+"button and SEEK- as "10-"button for fast search during USB and SD/MMC card operation. Press and hold SEEK+/SEEK- to fast forward or rewind the song in playing.



The marine unit can support playing the music in USB and SD/MMC card by inputing the song sequence number directly: when the unit is playing songs, press AS/PS button on the front panel, it will display "SCH 000" on the LCD, the three digits indicates the sequence number that you want to listen to. You can use preset key 1,2,3 to set the three digits by pressing them repeatedly and press ENT to confirm input, the unit will start playing the new song automatically. The remote control can also support this function: press GOTO key to enter this function, then press the number 0~9 to set the sequence number and press ENT to confirm input.

*IMPORTANT INFORMATION:

Note: some USB devices and SD cards may not be compatible with the unit
Some USB devices may take more than 45 seconds to initiate after plugging in.

DISC OPERATION

DISC PLAYING

- (1) Press() to power on.
- (2) Insert the CD/CD-R/CD-RW/MP3/WMA disc.
- (3) The LCD will display "disc style" " item number" "playing time".
- (4) Press "  " to play or pause the song.
- (5) Follow the function key instruction to do the operation.
- (6) Press "  " to stop playing and eject the disc, repress it to take in the disc and start to play.
- (7) You may press SEEK+ as "10+"button and SEEK- as "10-"button for fast search during disc operation. Press and hold SEEK+/SEEK- to fast forward or rewind the song in playing.

Note: After pressing the "  "key ,if the disc is not taken away within 5 seconds, the unit will take back the disc.

NOTES FOR CD

- (1) Keep the disk clean ,do not stick things on the disc.
- (2) Do not play the damaged or transformative disc, keep the disc correctly .
- (3) Do not keep the disc under sunshine or in high temperature environment .
- (4) Put the disc into its box after using.
- (5) Finger mark or besmirch will effect the disc playing quality, it can't be cleaned by soft cloth. If it is necessary , diluted natural solvent can be used to help clean the disc. Record cleaner or antistatic solvent can't be used to clean the disc.
- (6) The marine unit can support playing the music in the disc by inputing the song sequence number directly: when the unit is playing songs,press AS/PS button on the front panel, it will display "SCH 000"on the LCD, the three digits indicates the sequence number that you want to listen to. You can use preset key 1,2,3 to set the three digits by pressing them repeatedly and press ENT to confirm input, the unit will start playing the new song automatically. The remote control can also support this function: press GOTO key to enter this function, then press the number 0~9 to set the sequence number and press ENT to confirm input.

PRECAUTIONS

Choose the mounting location carefully so that the unit will not impair the safe operation of the vehicle, or interfere with the driver.

Avoid installing the unit where it would be subject to high temperatures, such as from direct sunlight or hot air from the heater, or where it would be subject to dust, dirt or excessive vibration.

Use only the supplied mounting hardware for a safe and secure installation.

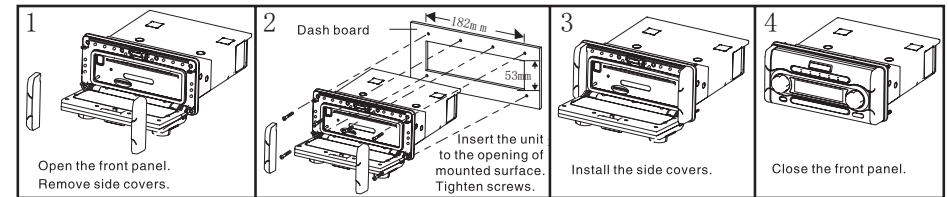

TO SUPPORT THE UNIT

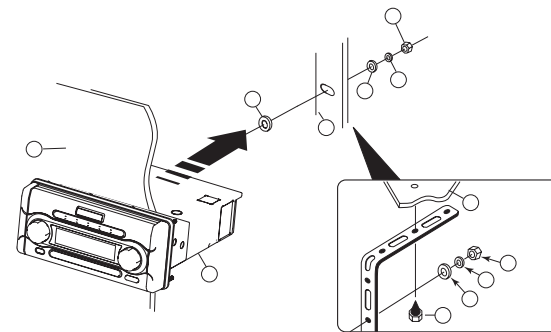

1. UNIT
2. DASH BOARD
3. HEX NUT M5
4. LOCK WASHER
5. PLAIN WASHER
6. MARINE BODY
7. REAR SUPPORT STRAP
8. TAPPING SCREW
9. M5x15 HEY BOLT

BASIC OPERATION

1. POWER(1): Power ON/OFF

2. VOLUME(3): Volume knob

3. PUSH SEL(3):

Press to select VOLUME BASS, TREBLE, BALANCE, FADER, SUBWOOFER, DSP, ID3.

Use VOL+/- to change the setting.

Long press to enter zone selection, stereo/mono switch and default volume settings.

A: Zone: USA, China and Euro, default is USA.

B: STEREO/MONO switch at FM mode

C: Default Volume setting: "P-VOL XX" is the default volume value when power on.

4. DISP(5)

This button can be used to adjust system time.

Short Press to display system time. The time display will be gone if no action in 5 seconds.

While the system time is on display, the hour icon will blink with a long press on this button.

User can use "TURN+/(2)" button to adjust hour. Press "DISP" button to select minute. While

the minute icon is blinking, user can use "TURN+/(2)" button to adjust minute.

The unit will exit the time setup mode if pressing other button or no action in 5 seconds.

This button is used to display the current channel info at Sirius mode.

5. MODE(6)

Switch mode between: RADIO, CD, USB, SD, AUX, iPod, SIRIUS.

6. LCD display (13) :

7. Open(12): Press this key to flip down the front panel

8. loading a disc

1) Press OPEN to open the front panel.

2) Insert a disc into the disc loading slot

3) Close the front panel.

9. Ejecting a Disc

1) Press OPEN to open the front panel.

2) Press the ▲ button to eject disc.

3) Close the front panel.

10. LOUDNESS

Long press Band key to turn loudness ON or OFF.

IPOD OPERATION

CONNECTING IPOD

You may connect your iPod through an iPod port at the rear of your unit, You need to purchase the iPod cable from the dealer to play the iPod.

PLAYING SONGS IN IPOD

1. Press **MODE** repeatedly until **IPOD** shows in display. The unit will play the songs in iPod automatically.

2. Press **PAUSE** to pause the playing. Press again to resume.

3. Press **MENU** to enter **IPOD** menu selection, you can turn the right knob(ENT) to switch between folders(PLAYLIST, ALBUM, ARTIST etc.) and press it to select the folder or play the songs. When you are selecting between the menus, simply press this key to return to up one level menu.

4. Fast search

Press **SEEK+** as "10+" button and **SEEK-** as 10- button.

5. Press and hold **SEEK+/SEEK-**, it will fast forward/rewind the song in playing.

If you are aware on how to use iPod, the way to use the marine CD-Receiver feature is basically just the same. Take note of the equivalent key function below.

Marine CD-Receiver	iPod	Function
Press ENT button	Press CENTER button	ENTER or Confirm action
Press MENU button	Press MENU button	Go back one level

Marine CD-Receiver and iPod equivalent key function

Note:

- . Refer to your iPod use 's manual for operating instructions.
- . Rotate ENT button for folder and file browsing. Push button to confirm selection

RADIO OPERATION

LISTENING TO THE RADIO

Press the (MODE) (6) button and select the radio mode. The frequency appears in the display.
Press the (BAND) (7) button and select the radio band FM1--FM2--FM3--AM1--AM2.

TUNING

There are 3 types of tuning mode available: SEEK tuning, MANUAL tuning and PRESET STATIONS.

AUTO SEEK A STATION

Press the (BAND) (7) button and select the desired band (FM or AM).
Press SEEK+/- to start to seek a station

MANUAL TUNING

The unit will seek station manually by turning the right knob.

STORING A STATION

Select a band (if needed)
Select a station
Hold a preset button [1-6] (4) for more than 2 seconds to store the desired station.

'SCAN' AUTOMATIC TUNING CONTROL (SCAN) (10)

This button operates as RADIO SCAN. The operation is similar to normal search, except it pauses for 5 seconds on every station detected while in RADIO SCAN mode.

SET USA/EUROPE FREQUENCY

Long press VOL key, it will display "USA" on the LCD, you can switch between USA, CHINA and EUROPE by turning the VOL knob.

SET FM/AM SENSITIVITY

Long press SEL key, it will display "ST 3" on LCD, this is used for changing channel separation.
Press SEL key again, it will display "AM DX 40DB" on LCD, this is used for setting AM sensitivity
Press SEL key again, it will display "DX 17DB" on LCD, this is used for setting FM sensitivity, you can use SEEK+/- to change the value.
When the sensitivity value is set to higher value, the unit will receive less station but the stations received will have better sound quality.
When the sensitivity value is set to lower value, the unit will receive more stations.

SIRIUS OPERATION

- This unit is compatible with a variety of SIRIUS Satellite Radio solutions including the SCC1 SiriusConnect™ Vehicle tuner Tuner and SCVDOC1 Sirius Connect Vehicle Kit with any compatible SIRIUS Dock & Play radio. The operation will be the same regardless of the SIRIUS radio is used .
- User needs follow the instruction of SCC1 or SCVDOC1 for installation. Always make sure the Sirius SIRIUS antenna is connected properly located for maximum signal reception.

1. Button definitions

- 1)Knob/ENT: User can turn the knob to select channels. It is also the "ENTER" button for command.
 - 2)Preset Buttons: Stations(1,2,3,4,5,6)
 - 3)DISP: Display the Sirius PDT info
 - 4)Band: Switch between SR 1, SR2 and SR3
 - 5) SEEK+/- (CAT+/-): short press to select between different categories such as: POP, ROCK, etc.
Long press (more than 2 seconds) to switch channel rapidly
 - 6)MENU: Category ON/OFF. When category is on, you can turn the right knob to select stations within current category.
 - 7) SCAN : Short press to LOCK/UNLOCK channels
Long press to change the password
 - 8)AS/PS: Short press to input channel number directly.
 - 9) Preset 1: During lock /unlock a channel or change password, press this button to change the first digit of the password.
It is also used to change the first digit when inputting channel # directly.
 - 10) Preset 2: During lock /unlock a channel or change password, press this button to change the second digit of the password.
It is also used to change the second digit when inputting channel # directly.
 - 11) Preset 3: During lock /unlock a channel or change password, press this button to change the third digit of the password.
It is also used to change the third digit when inputting channel # directly.
 - 12)Preset 4: During lock /unlock a channel or change password, press this button to change the to a four digit password.
- #### 2. Sirius ID and Activate Sirius service
- After system is turned on, you press the MODE button to enter the SIRIUS mode.
The system will display a "SIRIUS"logo on the LCD screen.

Until you subscribe and activate the SIRIUS service, you can only access channel 0 (the SIRIUS ID channel) and 184 (Preview Channel).

Tune to Channel 0 to display your radio's unique 12-digit SIRIUS ID number (SID). This number is also available on the back of SIRIUS Tuner SCC1. Write down this number and call 1-888-539-SIRIUS (1-888-539-7474) with your credit card handy to activate SIRIUS service.

You may go to website <https://activate.siriusradio.com//> to activate the service.

If you do not subscribe the full service, the unsubscribed channel will display "CALL 888-539-SIRIUS to subscribe" when tuned.

3. Preset Stations

The unit has total 18 preset stations in SIRIUS Mode. Use BAND button to switch between SR1, SR2, and SR3. Each band has 6 preset stations.

Short press: the Preset 1-6 button to listen to the preset stations.

Long press: the preset 1-6 to store current station to preset memory.

4. Select channels by category

Press MENU button to turn on/off the category mode. A "CAT" icon in the LCD will indicate the Category mode is on. When Category mode is on, the right knob can tune within the category only. Use Cat +/- to tune to next or previous category. The category mode will not time out unless you turn off this mode by pressing MENU button again.

5. Input channel directly.

Short press the AS/PS key to enter the direct input mode. The LCD will display: "CH X X X "

Press Preset 1 repeatedly to select the first digit of channel number (Press Preset 1 repeatedly to change the digit incrementally from 0, 1, 2, ... to 9).

Press Preset 2 to select the second digit of channel number.

Press Preset 3 to select the third digit of the channel number.

When 3 digits are selected, press "ENT" button to enter the desired channel.

6. Parental Control

You can lock any Sirius channels you do not others to have access without your permission.

The default code is "5220" if you forget your pass code, you may disconnect the unit completely from power. The unit will restore to the default pass code after power on again.

Enter a Locked channel:

When user tunes to a locked channel, the LCD screen will display: "LOCKED CH" first and then display: "CODE X X X X".

Press Preset 1 repeatedly to select the first digit of pass code.

Press Preset 2 repeatedly to select the second digit of pass code.

Press Preset 3 repeatedly to select the third digit of pass code.

Press Preset 4 repeatedly to select the last digit of pass code.

When all digits are selected, press "ENT" button will enter the channel.

If the code is wrong, it will display "CODE X X X X" again and wait for user to enter code again.

If user enters a wrong code again, the unit will display "PWD ERROR" and go back to previous screen.

Note: user needs wait for "CODE X X X X" display to enter pass code. Otherwise the Preset 1-4 still enters as Preset station.

To lock a channel:

When a channel is selected, use "SCAN" to lock this channel. The LCD will display "LOCK CH" first and then display: "CODE X X X X". Use Preset 1-4 (same as above) to enter pass code and press ENT to lock.

Note: After a channel is locked, user cannot tune to this channel by right KNOB button. User must input the channel # directly to enter this channel.

To unlock a channel:

User needs enter the locked channel first and then press "SCAN" button. The LCD will display "UNLOCK CH" and then display: "CODE X X X X".

Same procedure as above to enter the code and unlock the channel.

To change pass code:

Long press "SCAN" button to change the pass code. The screen will display "OLD CODE" shortly and then display "CODE X X X X" Use Preset 1-4 buttons as above to enter the pass code.

If the old pass code is entered correctly, the screen will display "NEW CODE" and the display: "SET X X X X" Use Preset 1-4 buttons again to set up a new pass code.

7. Display channel information:

Press DISP button repeatedly to display different information of the channel such as channel number, channel name, category, song title, artist, composer...

8. Message display:

"Check Sirius Tuner"	:	Tuner is not connected or is bad.
"Antenna Error"		Antenna is bad or not connected.
"Acquiring signal"		Acquire Sirius signal
"FW Updating "		Updates firmware
"Subscription updating "		Updates subscription
"Updating Channels "		Updates the GCI(Channel info)