

$\phi 11\ 3/4'' [298.20]$  MOUNTING HOLE DIAMETER

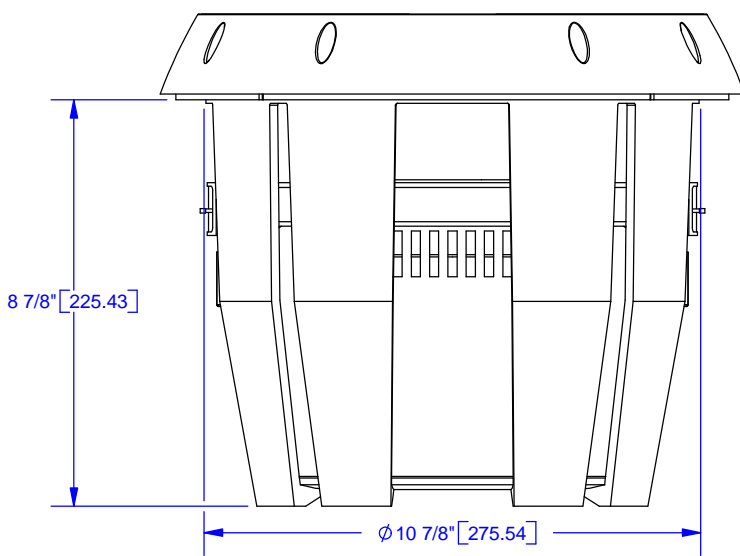

# TECHNICAL SPECIFICATIONS

PRODUCT NAME	T212D2	T212D4
NOMINAL DIAMETER	12" [305]	12" [305]
MAGNET WEIGHT	292 oz (8278 g)	292 oz (8278 g)
FREQUENCY RANGE	28 Hz-250 Hz	29 Hz-250 Hz
VOICE COIL DIAMETER	4.00" [101.6]	4.00" [101.6]
VOICE COIL WINDING WIDTH	1.97" [50]	1.97" [50]
VOICE COIL FORMER MATERIAL	ALUMINUM	ALUMINUM
NOMINAL IMPEDANCE	(2) 2 Ohms	(2) 4 Ohms
DC RESISTANCE (Re)	3.2 Ohms	6.4 Ohms
VOICE COIL INDUCTANCE	3.9 mH	5.6 mH
RESONANCE FREQUENCY (Fs)	28 Hz	29 Hz
MECHANICAL Q FACTOR (Qms)	5.04	4.72
ELECTRICAL Q FACTOR (Qes)	0.41	0.48
TOTAL Q FACTOR (Qts)	0.38	0.44
COMPLIANCE (Cms)	1.00E-04 m/N	1.00E-04 m/N
EQUIVALENT AIR VOLUME (Vas)	0.93 FT <sup>3</sup> (26.4 LITERS)	0.93 FT <sup>3</sup> (26.4 LITERS)
MOVING MASS (Mms)	11.26 oz (319.1 g)	10.62 oz (301.1 g)
MECH. RESIST. LOSSES (Rms)	11.21 kg/s	11.63 kg/s
SENSITIVITY (SPL) W/M	85 dB	85 dB
FORCE FACTOR (BL)	21.0 T-m	27.0 T-m
EFFECTIVE CONE AREA (SD)	67 in <sup>2</sup> (0.043 m <sup>2</sup> )	67 in <sup>2</sup> (0.043 m <sup>2</sup> )
LINEAR EXCURSION (X-MAX)	0.75" [19]	0.75" [19]
OPERATING POWER (PE)	1000 W RMS/2000 W PEAK	1000 W RMS/2000 W PEAK
EFF. BANDWIDTH PROD. (EBP)	68	60
MOTOR CONSTANT (Krm)	78.91 mOhms	90.28 mOhms
MOTOR CONSTANT (Erm)	0.629	0.664
MOTOR CONSTANT (Kxm)	417.39 mH	735.35 mH
MOTOR CONSTANT (Exm)	0.466	0.446
MOTOR IMPEDANCE (Rem)	19.33 Ohms	30.03 Ohms

THIELE-SMALL MEASUREMENTS MADE WITH VOICE COILS IN SERIES.  
 SPECIFICATIONS MAY VARY PER MANUFACTURING TOLERANCES AND ARE SUBJECT TO IMPROVEMENT WITHOUT NOTICE.

DESCRIPTION: 12 INCH POWER STAGE 2 WOOFER		RELEASE & DATE: #1 (5-11-04)	
ENGINEER:	DATE: 5-11-04	SCALE: 1:4	CREATED IN SOLIDWORKS
DOC CON:	SHEET: 1 OF 1	UNITS: INCHES [MILLIMETERS]	ROCKFORD ACOUSTIC DESIGNS
			3056 WALKER RIDGE DRIVE SUITE G WALKER, MI 49544